

# SPARK

FLEXIBLE  
CONVEYOR  
CUTTING

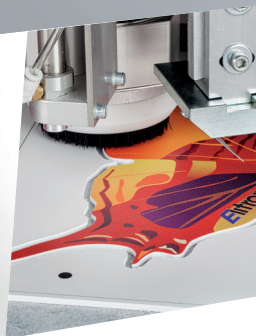

**Elitron**   
ROBOTIC CUTTING INTELLIGENCE

# SPARK

MAXIMUM FLEXIBILITY  
MAXIMUM PRODUCTIVITY  
MAXIMUM RESULTS

Spark meets and surpasses today's finishing requirements, both in terms of flexibility and automatic cutting performance, for sampling and production in **digital printing, cardboard, sign and display industries**. More than 25 years of Italian manufacturing experience, and technological innovation, come together to ensure that **Elitron** offers you the most advanced technology and high-performance **multi-tool cutting heads for cutting, milling, creasing and engraving**. Only **Elitron's** systems can be equipped with the **Seeker System**, the intelligent vision system which automatically recognises printed images. This **exclusive Elitron patent** significantly reduces production time and cuts the cost of the production process.

## MAIN CHARACTERISTICS

Multi-tool head to cut, crease **materials up to 25 mm**.

Integrated, patented **Seeker System** to automatically recognise printed images and reference marks.

Possibility to work **different materials during the same session**, without changing tools.

**Speed up to 70 m/min, acceleration 0,8G.**

Video projection system to **optimise material yield**, and re-use otherwise waste materials.

**High precision** movement mechanisms.

Working area divided into powerful concentrated vacuum sectors, for **maximum material hold on the working surface**.



### Exclusive Elitron patent

Innovative vision system, entirely **designed, developed and patented by Elitron**. Automatically identifies

the location of printing reference points on the materials, to **automate the digital finishing process**.

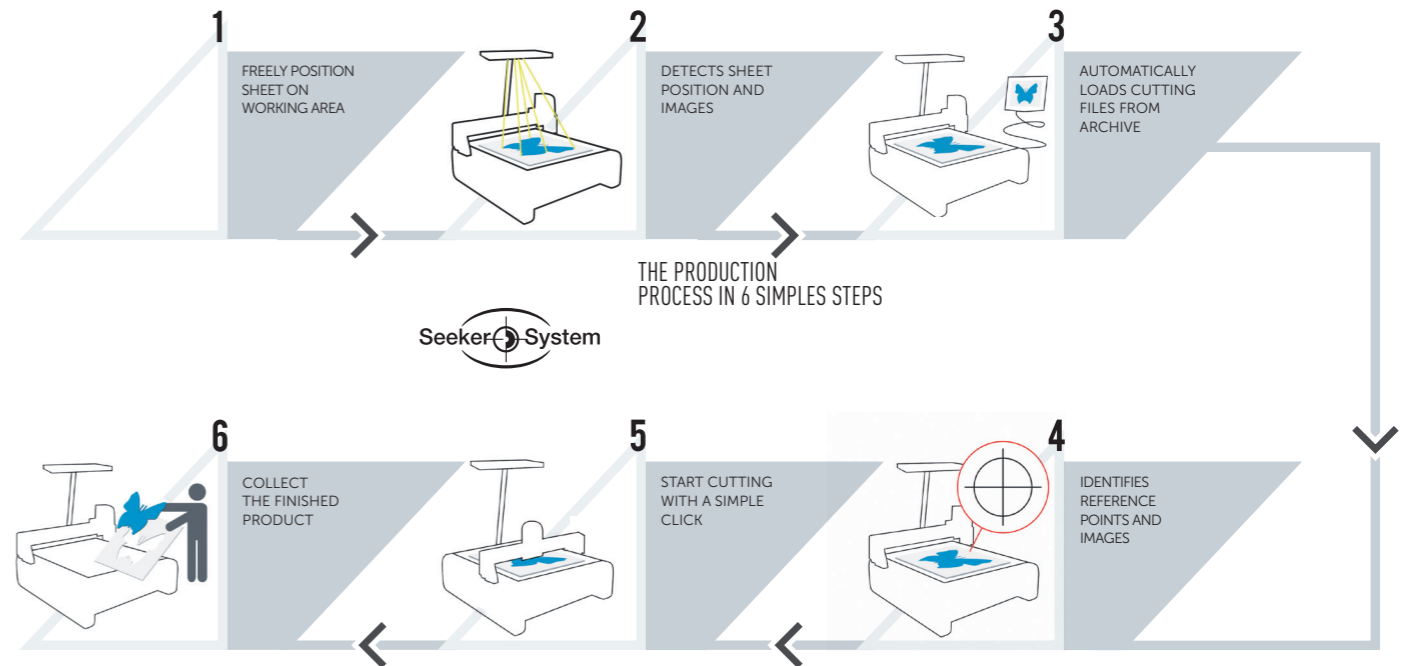

### Multi-tool head

**Maximum flexibility** during production, using the multi-tool cutting head equipped **with up to 4 tools simultaneously**, for all production requirements: furthermore, the impressive software features allow **different materials to be worked during the same production session**.

- Cutting head with fixed or oscillating knife, electric and/or pneumatic
- 1 kW Electro spindle milling module with manual tool change
- Creasing wheel kit with different diameters and profiles
- Kiss-cutting (half cut)
- V-cut, 45° knife (other cutting angles also available)
- Cut & Crease knife
- Circular knife
- Pen module
- Laser pointer



### Supplied with optional:

- **roll holder**;
- **feeding system** for roll materials;
- **holding clamp** to ensure precision advancement of even the most critical materials;
- **synchronized unloading table** to facilitate the collection of finished materials.



### Seeker System PRO

**Seeker System PRO** increases productivity during every single working cycle. The dual camera system with powerful image processing software automatically scans the working area, **recognises printed images and loads the corresponding cutting files automatically**. **Seeker PRO** can process different materials **simultaneously** without having to place the sheets in any particular position on the working area.

### Underside Roll Reader

**Innovative system** able to **recognise printed images on roll materials** from the underside. Automatically loads the relative cutting files, for a continuous, highly productive workflow.

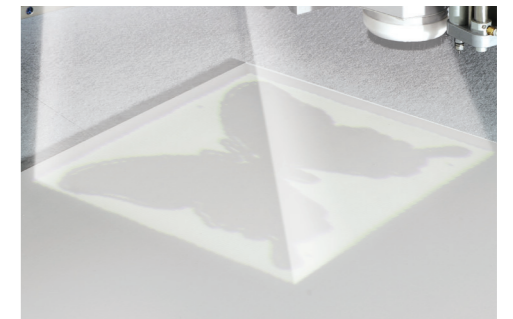

### Video Projection

**Yield optimisation** using the video projection system to project digital dies onto the materials. **Waste and cost reduction**, with possibility to **re-use otherwise waste materials**.

## MATERIALS FLEXIBILITY FOR ALL

Processes a wide range of roll and rigid materials with extreme precision.

- Forex
- Dibond
- PVC
- Plastics
- Films
- Re-board
- Paper and cardboard
- Corrugated cardboard
- Foam
- ... and many more



## APPLICATIONS MATERIAL TAKES SHAPE

No limits to your productivity:

- Packaging
- POS displays
- Transparent containers
- Advertising banners
- Folders
- Binders
- Boxes
- Embossed logos
- Promotional trade fair stand panels
- Promotional flags
- Brochure holders
- ... and many more

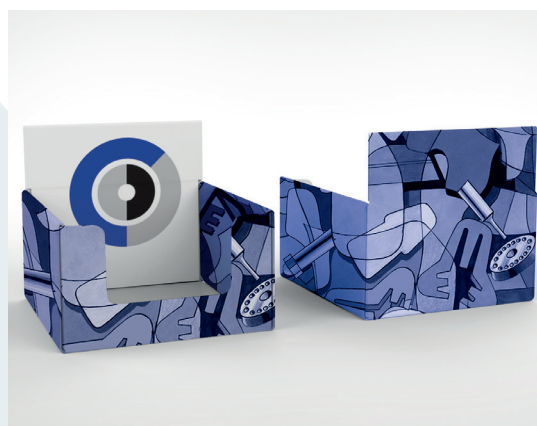

## TECHNICAL INFORMATION

	SPARK	
	Standard	With video projection *
<b>Version</b>	Standard	With video projection *
<b>Working Area (mm)</b>	1900 x 1600	
<b>Machine dimensions (mm)</b>	2620 x 2360	2800 x 2750
<b>Machine height (mm)</b>	1300	3300
<b>Working area height (mm)</b>	910	
<b>Electric power supply</b>	Triphase 400V 50/60Hz 9kW	
<b>Pneumatic air</b>	8 bar 600l/min	

\* Video projection: optional.

The technical specifications indicated in the table may be updated and modified as a result of any improvements and technology developments.

The images shown are for illustration purpose only.



**ELITRON IPM srl**  
Viale I Maggio, 42  
63813 Monte Urano (FM)-Italy.

+39 0734.842221  
elitron@elitron.com  
[www.elitron.com](http://www.elitron.com)

**Elitron**   
ROBOTIC CUTTING INTELLIGENCE